



NOT LEGAL FOR SALE OR USE ON ANY POLLUTION
CONTROLLED MOTOR VEHICLE IN CALIFORNIA OR
STATES ADOPTING CALIFORNIA EMISSION PROCEDURES.
See knfilters.com for CARB status on each part for a specific vehicle

INSTALLATION INSTRUCTIONS

77-2594KC
FORD
2020-21 EXPLORER
2.3L ECOBOOST

TOOLS NEEDED:

- Flat blade screw driver
- Ratchet
- Extension
- 10mm socket
- 8mm wrench
- 6mm wrench
- 4mm allen key

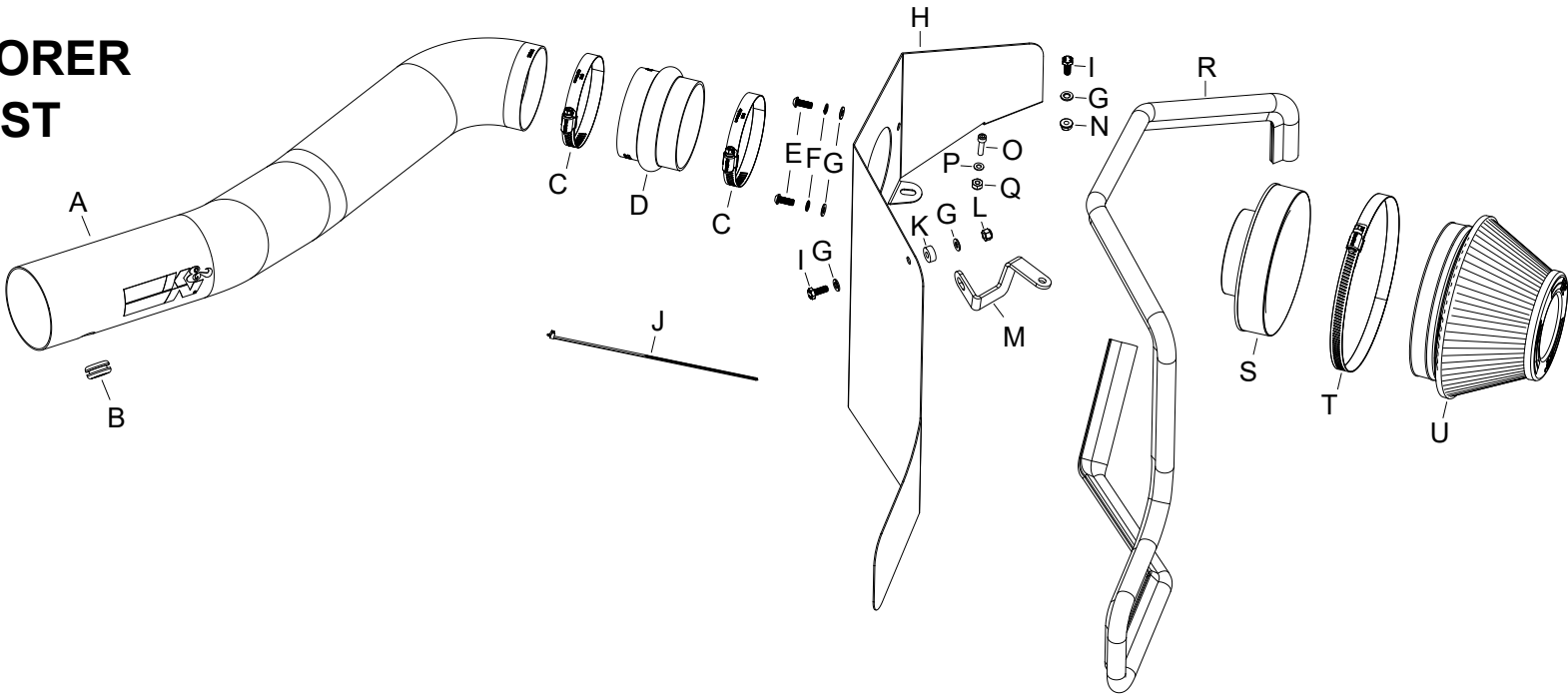

PARTS LIST:

Description	Qty.	Part #	Description	Qty.	Part #	Description	Qty.	Part #
A TUBE; 3.5"OD X 31"L	1	25844C	H HEAT SHIELD; MILD STL	1	073315	O BOLT; 5MM-.80 X 20MM, ALLEN	1	08320
B GROMMET; 1"OD, 1/2"ID, 1/2"	1	08064	I BOLT; M6 X 1 X 20MM HEX	2	07795	P WASHER; 5MM FLAT	1	08212
C HOSE CLAMP; #56	2	08620	J CABLE TIES; 11" BLACK	1	21590	Q NUT; M5 X 0.8", NYLOCK	1	07507
D HOSE; HUMP 3.5"ID X 2.5"L	1	08699	K SPACER; .625" OD X .250"ID	1	06555	R EDGE TRIM; 61"L	1	102492A
E BOLT; M6 X 1 X 16MM	2	07730	L NUT; 6MM NYLOCK, HEXHEAD	1	07512	S ADAPTER; 6" FILTER 3.5"	1	21512-1
F WASHER; M6 SPLIT LOCK ZINC	2	1-3025	M BRACKET; Z	1	064366	T HOSE CLAMP; #104	1	08697
G WASHER; 6MM FLAT	5	08269	N NUT; M6, HEX, SERRATED	1	444.460.04	U AIR FILTER	1	RU-46000

If you need any assistance please call 1-800-858-3333 to speak with a representative in our Customer Service Center before returning the product.

NOTE: FAILURE TO FOLLOW INSTALLATION INSTRUCTIONS AND NOT USING THE PROVIDED HARDWARE MAY DAMAGE THE INTAKE TUBE, THROTTLE BODY AND ENGINE.

TO START:

1. Turn off the ignition and disconnect the negative battery cable.
NOTE: Disconnecting the negative battery cable erases pre-programmed electronic memories. Write down all memory settings before disconnecting the negative battery cable. Some radios will require an anti-theft code to be entered after the battery is reconnected. The anti-theft code is typically supplied with your owner's manual. In the event your vehicles anti-theft code cannot be recovered, contact an authorized dealership to obtain your vehicles anti-theft code.



2. Loosen the hose clamp that secures the intake hose to the air filter housing and disconnect the hose from the housing. Disconnect the inlet air temperature sensor electrical connection



3.Release the spring clips that secure the upper air filter housing to the lower housing and then remove the upper housing and factory air filter.



4.Remove the mounting nut securing the lower air filter housing, release the tabs securing the fresh air inlet duct and then remove the lower housing.



5. Release the two tabs that secure the fresh air duct to the inlet in the core support and remove the fresh air duct.
NOTE: It will be difficult to see that tabs securing the duct. If necessary, remove the charge tube to gain visual access to the tabs.
NOTE: K&N Engineering, Inc., recommends that customers do not discard factory air intake.



6. Install the provided edge trim onto the heat shield as shown, some trimming of the edge trim will be necessary.

Continued

INSTALLATION INSTRUCTIONS



7. Install the filter adapter into the heat shield and secure with the provided hardware.



8. Install the provided bracket onto the heatshield as shown using the provided hardware.



9. Install the heat shield into the vehicle as shown.



10. Secure the rear mount of the heat shield near the strut tower with the hardware provided.



11. Secure the lower front heat shield tab with the hardware provided.



12. Remove the hood prop bolt, align the upper heat shield mounting bracket and reinstall the hood prop bolt.



13. Install the hump coupler onto the filter adapter and secure with the provided hose clamp.



14. Remove the inlet air temperature sensor from the factory air filter housing, remove the O-ring and then install it into the K&N intake tube using the provided grommet.



15. Install the intake tube into the factory turbo inlet and then into the hump coupler, align for best fit and then secure with the provided hardware.



16. Secure the coolant hose using the provided tie wrap.



17. Reconnect the inlet temperature sensor electrical connection.



18. Install the K&N air filter and secure with the provided hose clamp.



19. Reconnect the vehicle's negative battery cable. Double check to make sure everything is tight and properly positioned before starting the vehicle.

20. It will be necessary for all K&N® high flow intake systems to be checked periodically for realignment, clearance and tightening of all connections. Failure to follow the above instructions or proper maintenance may void warranty.

ROAD TESTING:

1. Start the engine with the transmission in neutral or park, and the parking brake engaged. Listen for air leaks or odd noises. For air leaks secure hoses and connections. For odd noises, find cause and repair before proceeding. This kit will function identically to the factory system except for being louder and much more responsive.

2. Test drive the vehicle. Listen for odd noises or rattles and fix as necessary.

3. If road test is fine, you can now enjoy the added power and performance from your kit.

4. K&N Engineering, Inc., requires cleaning the intake system's air filter element every 100,000 miles. When used in dusty or off-road environments, our filters will require cleaning more often. We recommend that you visually inspect your filter once every 25,000 miles to determine if the screen is still visible. When the screen is no longer visible some place on the filter element, it is time to clean it. To clean and re-oil, purchase our filter Recharger® service kit, part number 99-5050 or 99-5000 and follow the easy instructions.

NOT LEGAL FOR SALE OR USE ON ANY POLLUTION CONTROLLED MOTOR VEHICLE IN CALIFORNIA OR STATES ADOPTING CALIFORNIA EMISSION PROCEDURES.
See knfilters.com for CARB status on each part for a specific vehicle

* FREE K&N® decal To register your warranty, please see us online at knfilters.com/register. FREE K&N® decal *